

upCentric®

Height Adjustable Rectangular Desks



ergoCentric®
The science of sitting™

Ergonomic, Stylish, Easy to Adjust and Assemble

The upCentric Electric Height Adjustable Rectangular Desks are designed to encourage movement to employees required to sit for extended periods of time; to decrease stress and tension, and to increase productivity and employee satisfaction.

Gyro Sensor - Anti-Collision Solution

All upCentric height adjustable desks include a patented Gyro sensor anti-collision system for enhanced safety and reduced injuries and damage to property.

Pre-settable Memory Positions - One-Touch Adjustment

Moving the desk is intuitive with the easy-to-use up/down control and four settable memory positions. Simply press the button with preset position and the desk will automatically adjust to your desired position.

Easy to Assemble - Save Your Time

We understand how important easy-assembly is to people looking for height adjustable tables, which is why we've made the upCentric assembly as easy as possible.

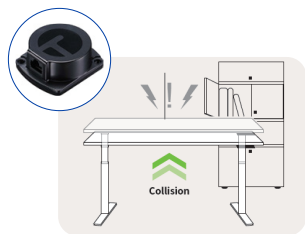

Gyro-Sensor



Pre-settable Memory Positions

Specifications

- Size range:
 - 2LV desks: 24"d x 48"w - 36"d x 84"w
 - 2L desks: 24"d x 30"w - 36"d x 96"w
- Height range: 22.6" - 49"
- Weight capacity: 270 - 140 lbs
- 1" HPL tabletop surface, available in 12 laminate finishes
- Frame available in Silver, Black, and White¹
- Standard grommet placement
- Various power and wire management accessories available
- Dual electric TiMotion® motors
- Sound level: 39dB
- Assembly time: 15 -25 minutes

(¹White is not available on Modular or 2LV upCentric frames.)

Warranty*

- 12 year limited warranty
- 7 year warranty: motors, wires and all electronic components

* Includes parts & labour.

High Pressure Laminate (HPL) Finish



23 Wild Cherry

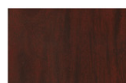

24 Figured Mahogany



27 Black

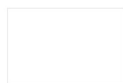

28 Designer White



31 Charcoal



37 Manitoba Maple



38 Sap Walnut



39 White Cypress



41 Light Grey



42 Graphite Wood

